

NEW DESIGN DM SERIES



In the active version of the DM series, the body frame consists of 3 parts (Main Body + Upper Body + Lower Body). These 3 parts are combined with the Mig welding method and after sanding, they reach clean surfaces on the welded edges. In the new version, the body frame will consist of 1 piece and will be welded from 4 corners that do not require grinding.

Thanks to the new version bending and welding method;

- The body frame will be stronger during transportation, its weight-loading capacity will be higher, and it will be stronger in dynamic and static loads.
- There is no risk of breakage of welded edges.
- There is no ripple on the top, bottom, or back surfaces.

NEW DESIGN DM SERIES

BENDING & WELDING TYPE OF BODY FRAME

OLD VERSION

tekpan[®]
INDUSTRIAL ENCLOSURES & CABINETS

NEW VERSION

In the active version, the entrance size of the body is 56mm narrow than the outer size of the body. In a new version, the entrance size will be 30mm narrow than the outer size of the body. So the new version entrance size of the body will be 26mm wider.

The mounting plate size will be wider 20mm on the width position, will be wider than 20mm in the height position.

The door usage size will be wider 20mm on the width position, will be wider 20mm on the height position.

NEW DESIGN DM SERIES

WIDER USAGE AREA

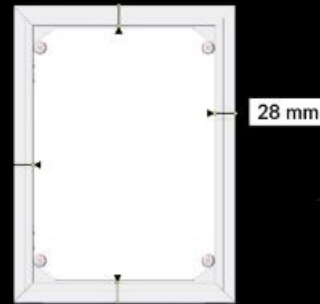

28 mm

20 mm



OLD VERSION

tekpan[®]
INDUSTRIAL ENCLOSURES & CABINETS

✓ NEW VERSION

In the active version, the press height of the gland plate's hollow will be larger and the fastening swrews' heads will be smaller. Thanks to this new method, the bottom surface of the body will be flatter.

Additionally, earthing contact part will be used at the gland plate for more earthing capability.

NEW DESIGN DM SERIES

GLAND PLATE

3 / 10

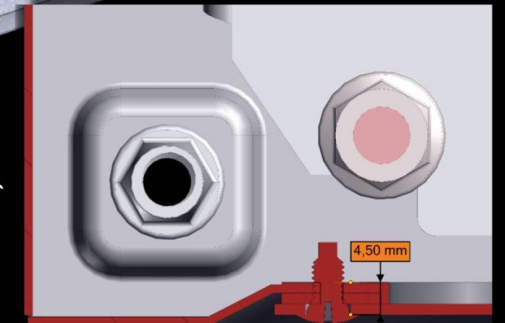
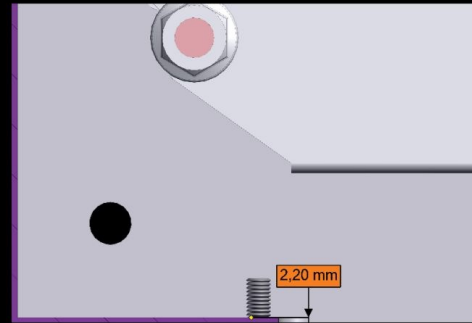

OLD VERSION

✓ NEW VERSION

NEW DESIGN DM SERIES

WALL BRACKETS

In the active version, the fixing of wall brackets needs to use a nut and screw at the same time, And also needs to fix from inside the enclosure. In some cases, 2 people are required for fixing.

In the new version, nut rivets will be in place so that fixing the wall brackets can be done only from outside by only 1 person.

An emboss form was added to the wall bracket fixing position to get stronger for loading capacity with wall brackets. Wall bracket design will give the possibility to the assembler to fix the enclosure from different directions.



OLD VERSION



NEW VERSION

In the active version, the fixing of wall brackets needs to use nuts and screws simultaneously and fix from inside the enclosure. In some cases, 2 people are required for fixing.

In the new version, nut rivets will be in place so that fixing the wall brackets can be done only from outside by only 1 person.

An emboss form was added to the Wall bracket fixing position to get more strong for loading capacity with Wall brackets

Wall bracket design will give the possibility for the assembler to fix the enclosure from different directions.

NEW DESIGN DM SERIES

INTERNAL SCREWS & RAILS

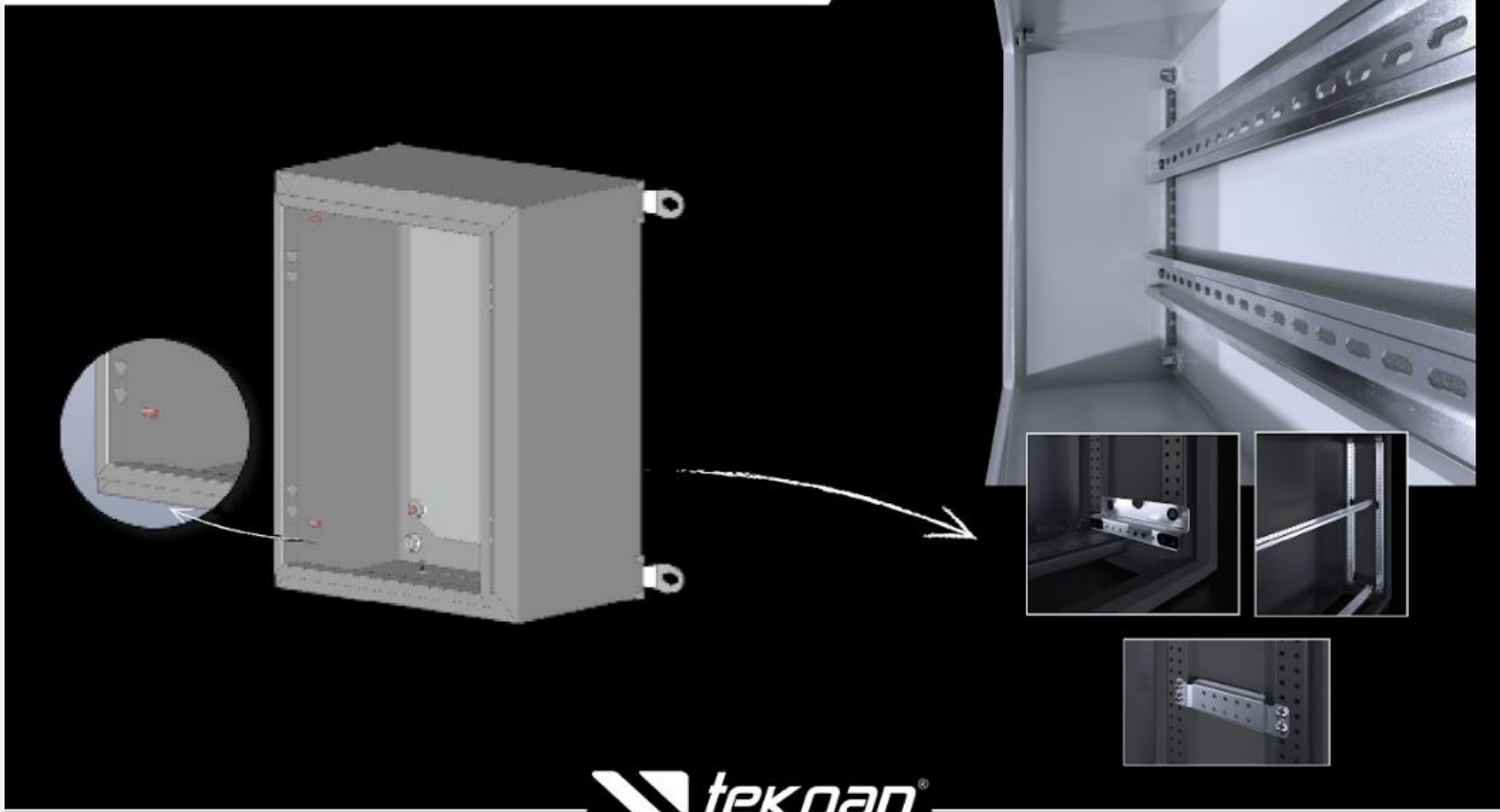

OLD VERSION



NEW VERSION

4 on left and 4 on the right total of 8 welded studs will be added to the internal sides of the body frame.

Thanks to these studs the rail fixing combinations and variable accessories can be loaded into an enclosure easily and modularized.

NEW DESIGN DM SERIES

DOORS

6 / 8

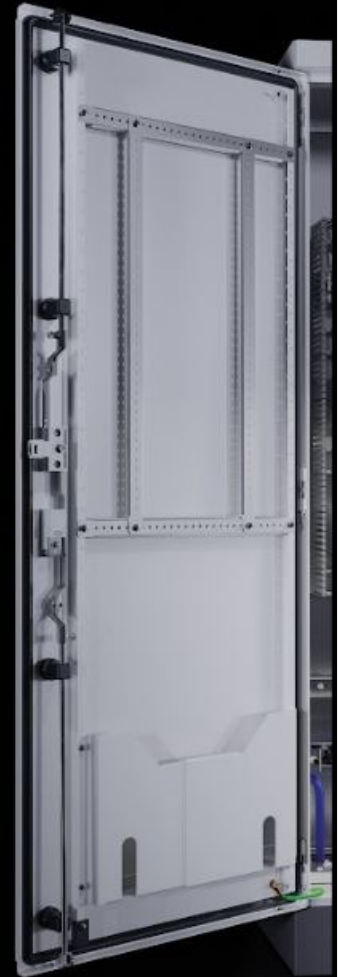
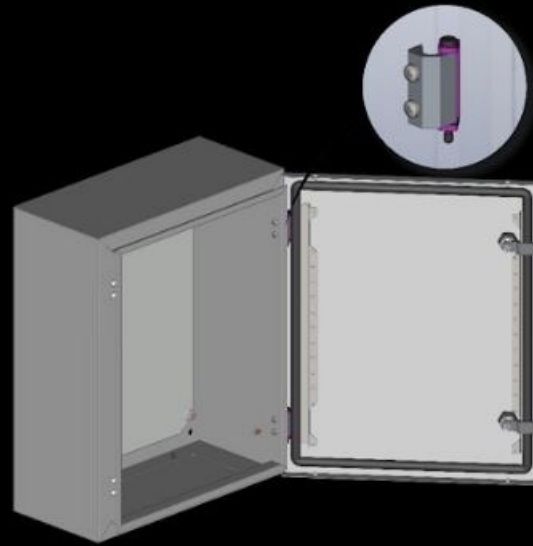

OLD VERSION

tekpan[®]
INDUSTRIAL ENCLOSURES & CABINETS

✓ NEW VERSION

NEW DESIGN DM SERIES

DOUBLE DOORS

Door Stability with door support part

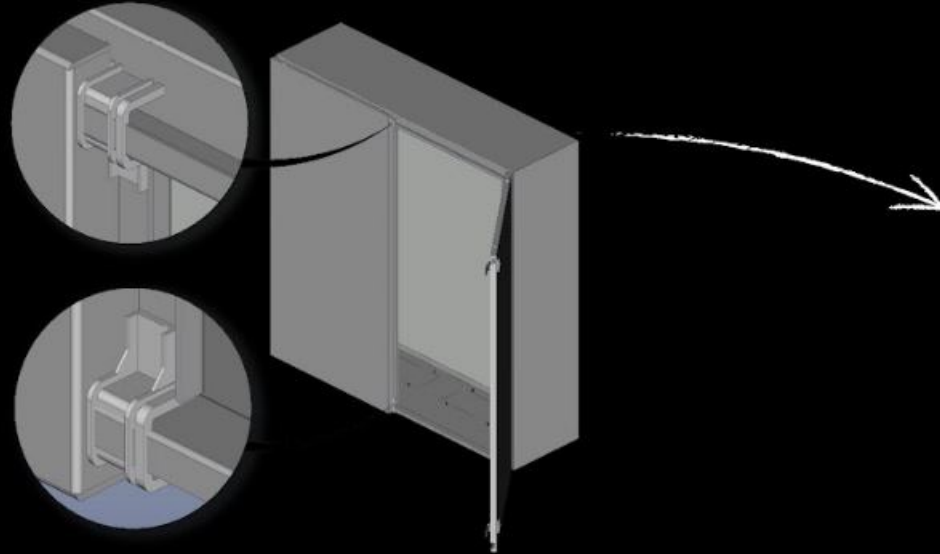

In the active version, there are hinge spaces during the opening position. That can be felt by movements on the door. In the new version, the hinge system will be completely changed to be more strong and more stable.

A plastic door guide and supporter will be added inside the door to protect the direction of the door against heavy loads or unsquared placements.

Radius-shaped corner application will be used at door corners for a better good looking and strength on the surface.

OLD VERSION

tekpan[®]
INDUSTRIAL ENCLOSURES & CABINETS

✓ NEW VERSION

NEW DESIGN DM SERIES

DOUBLE DOORS

Strong 3-point lock structure

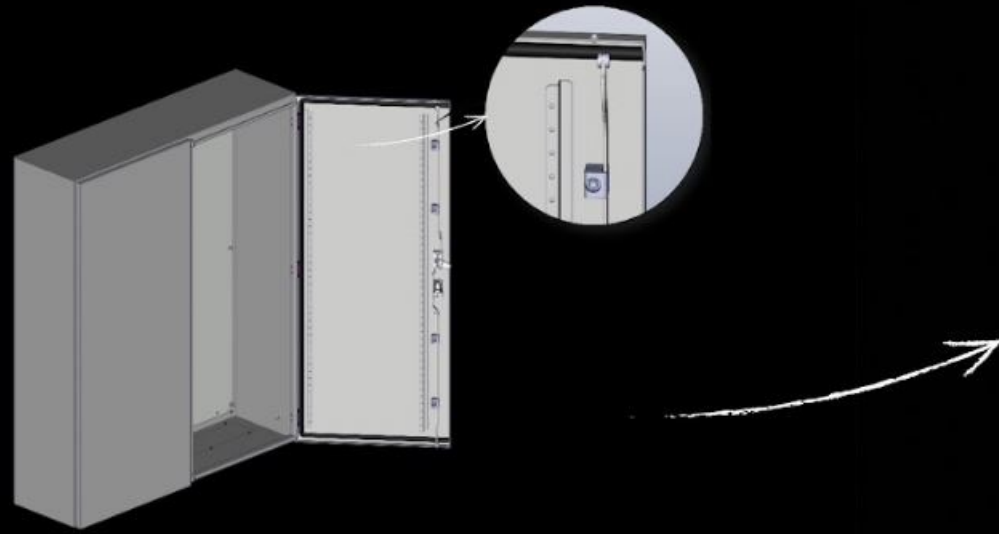

OLD VERSION



NEW VERSION

New gasketing and locking support system will be used in double door applications for a better isolation and locking system. In active version , if the doors are not close with squared , the gasket fits its place that needs with harder press. At new design it will be not.

2 points or 3 points locking positions, left and right doors will have locks for more strong locking.

NEW DESIGN DM SERIES

USING AS A FLOOR STANDING ENCLOSURES OF LARGE ONES

Floor standing compatibility with ready to use Plinth holes.

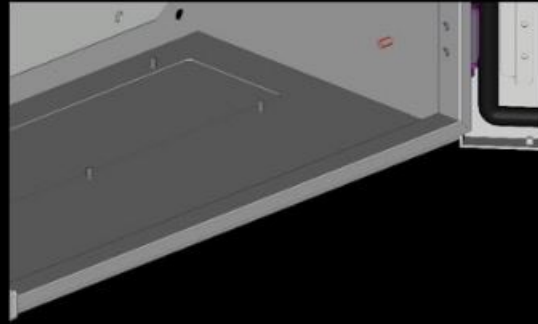

Our new DM products are available with plinth accessories that make it possible to use the free-standing of the Large series.

There are holes in the gland plate of DM Large series of enclosure that is ready for a protected plinth connection.

Our DM Large series enclosures can be used as a plinth sewing type in a very practical way following the usage area and preference.

OLD VERSION



NEW VERSION

Internal access to the plinth has been provided to make it convenient for the use of the floor-standing type of the Large series of our new DM products.

The gland plate can be removed from the inside of the board and the use of the plinth will not interfere with this activity.

In this way, the installation flexibility and time-saving of our enclosures, which are preferred to be used as floor standing, have been achieved.

NEW DESIGN DM SERIES

USING AS A FLOOR STANDING ENCLOSURES OF LARGE ONES

Floor standing compatibility with interior Access gland plate

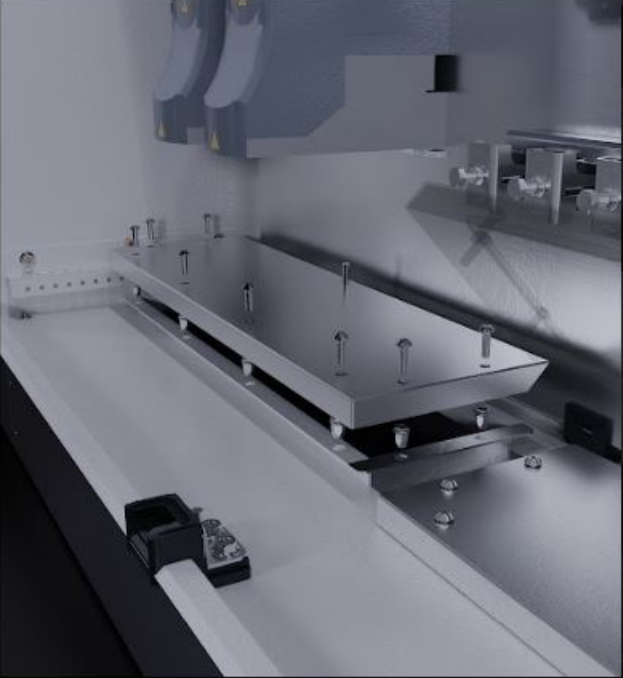
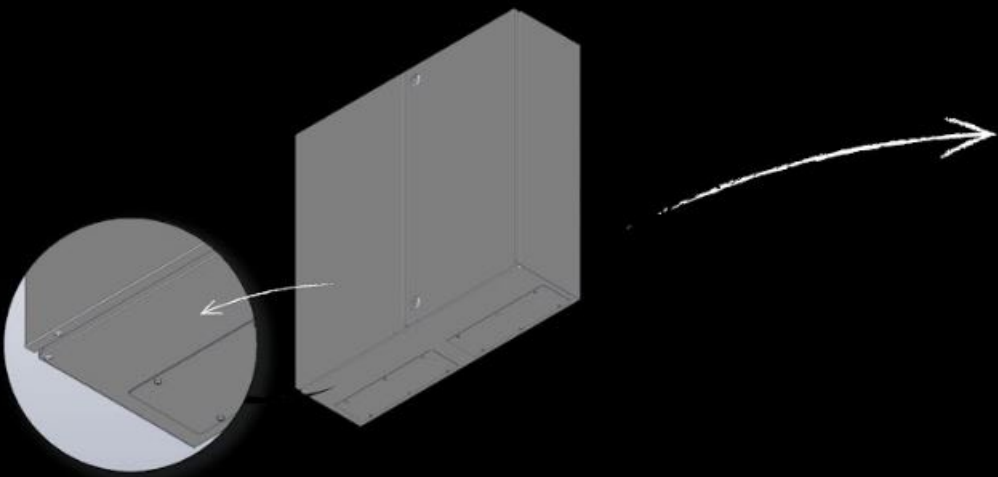

OLD VERSION



NEW VERSION